

MOONBASE ALPHA TECHNICAL NOTEBOOK

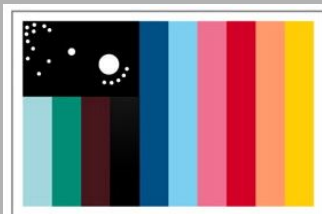
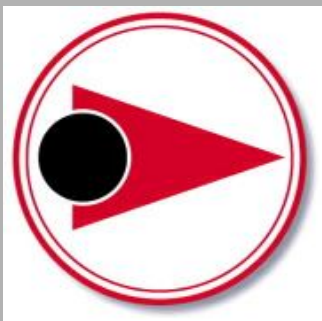
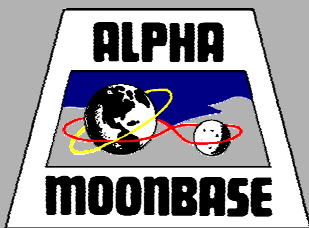

Internal Structures

Alpha-1006

LEVEL J is the lowest level in use on Moonbase Alpha. Here are the hangars and service bays for the Eagle Spacecraft and the necessary control centers for Moonbase operations should the upper level control stations ever become useless.

The SECURITY RESEARCH STATION is located in a small crater at the edge of Plato. Cut off from the rest of the Moonbase, dangerous experiments can be carried out here without endangering the safety of Alpha. Bulkhead doors within the Travel Tube can completely isolate the Moonbase.

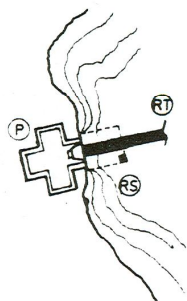

KEY-Research Station

- (P) Landing Pad
- (RT) Travel Tube to Research Station
- (RS) Research Station Built Within Small Crater Wall

LEVEL J

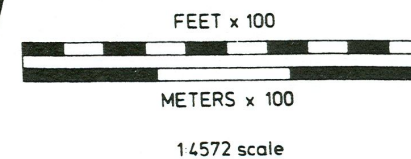
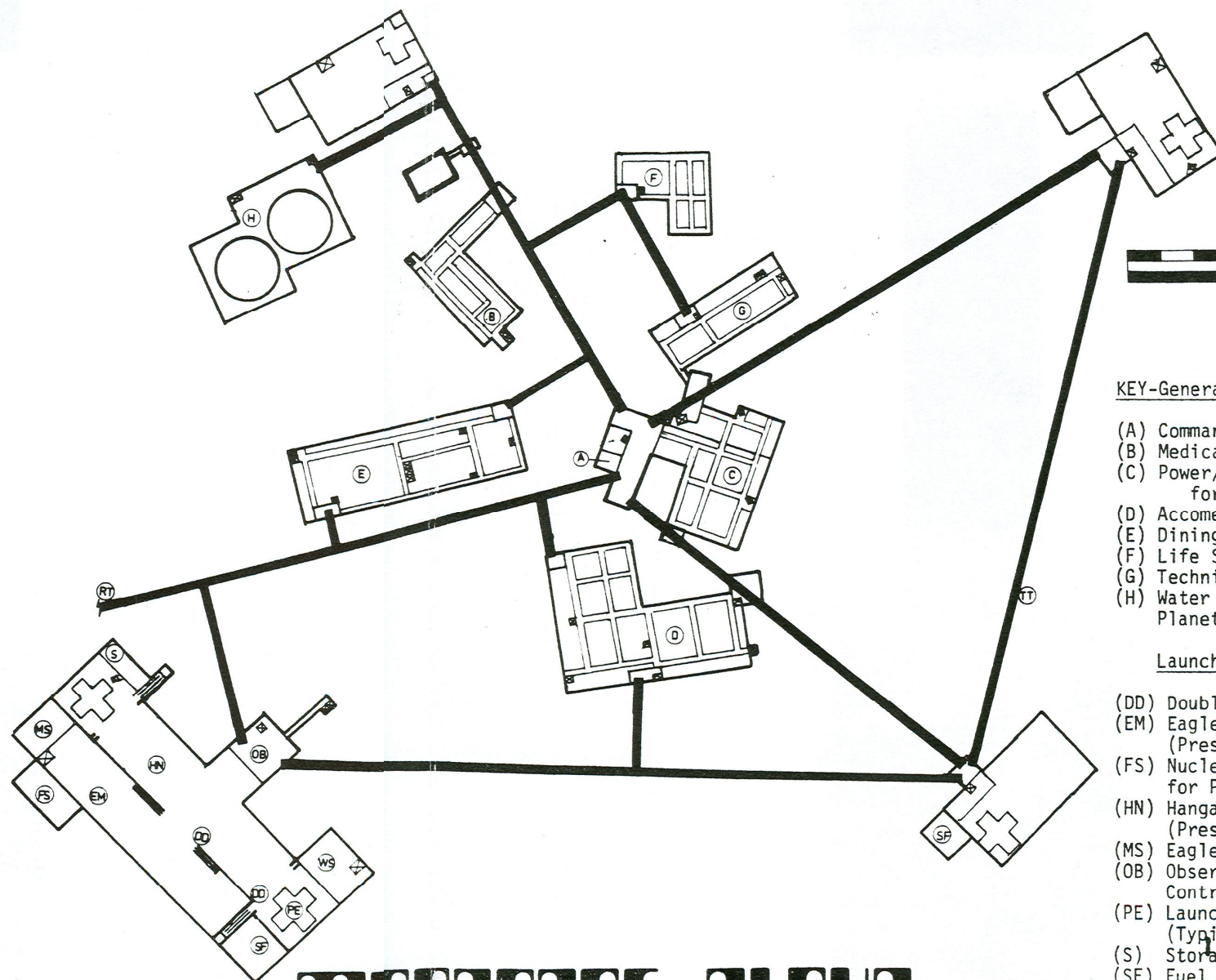

KEY-General Areas

- (A) Command Center
- (B) Medical Center
- (C) Power/Life Support Section for Level J
- (D) Accommodation Unit
- (E) Dining Facility
- (F) Life Support Equipment
- (G) Technical Labs
- (H) Water Recycling and Storage Planet (Lower Level)

Launch Pads

- (DD) Double Doors
- (EM) Eagle Maintenance Bay (Pressurized Area)
- (FS) Nuclear Furnace (Lower Level) for Parts Fabrication
- (HN) Hangar Section (Pressurized Area)
- (MS) Eagle Module Storage
- (OB) Observation Balcony and Control Area
- (PE) Launch Pad Lift Platform (Typical)
- (S) Storage Bays
- (SF) Fuel Storage

- (TT) Travel Tube (Typical)
- (RT) Travel Tube to Research Station

- Elevator
- Travel Tube Terminal

MOONBASE ALPHA